



## ***Transit YP***

### Trolleys



Trolley designed for transportation and storage of glasses and panels in the assembly lines.



### Partitioning

The carriage has doubled partitioning that allows high increase in the number of transportable workpieces and also considerable savings in terms of occupied space.



### Contact surfaces

All side and lower contact surfaces are coated with soft nonslip PVC, which ensures the integrity of the surfaces in the housing stages.

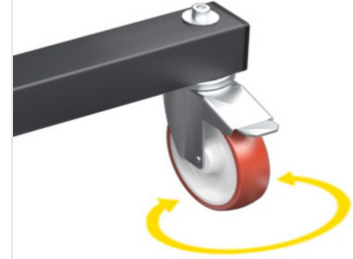

### Pivoting wheels

Equipped with 4 pivoting wheels with brakes, they ensure a high degree of mobility and easy handling of the object. Locking the braking units allows their position to be fixed near different work areas.

**TRANSIT YP / TROLLEYS****CHARACTERISTICS**

Compartment depth (mm)	999
Base (mm)	1.240 x 1.010
Vertical support, height (mm)	1.305
Number of compartments	10 x 2
Soft PVC contact surface	●
Wide supporting base	●
Handle for moving	●
4 swivel casters, 2 of which have locking stops (mm)	Ø = 125
Weight (kg)	85
Load capacity (kg)	500

Included ● Available ○