

Our know-how - your advantage

The CNC controlled two head cleaning machine SV 840 ensures exact and, above all, efficient machining of PVC window frames. Due to the turnable toolings, turning of the frame is not necessary so that the machine's dynamics is maintained.

The useful arrangement of machining tools as well as software controlled parallel operation up to the indicated minimum dimension allow for extremely short throughput times. Furthermore, the three dimensional operation method installed as standard of 7 or 13 electronically positionable AC servo axes also ensures flexibility and efficiency. They control the machine via freely programmable CNC control with production recording and optionally the profile identification with the possibility of transmission to downstream machinery or machining operations. Moreover, there are standard serial interfaces applied for online operation to ensure receiving and sending of data to other upstream or downstream machines or PC units.

Standard tooling consists of 4 cutting/grooving knife units, 4 inside cleaning knife units, 4 drilling/milling units and 2 disc cutting units. Numerous special tools are optionally available offering a variety of machining possibilities: Knife cutting unit vertical / horizontal, inside cleaning knife unit for bevelled inner corners and radii as well as for outer corners on frames with different widths and overlap sashes, cross corner brackets etc.

The special clamping and centering system of the SV 840 allows for V- or trapezoid shaped transom weldings in one processing step. Furthermore, the special "catch" function ensures fast reclamping from frame top to frame bottom.

SV 840

CNC-Corner Cleaning Machine

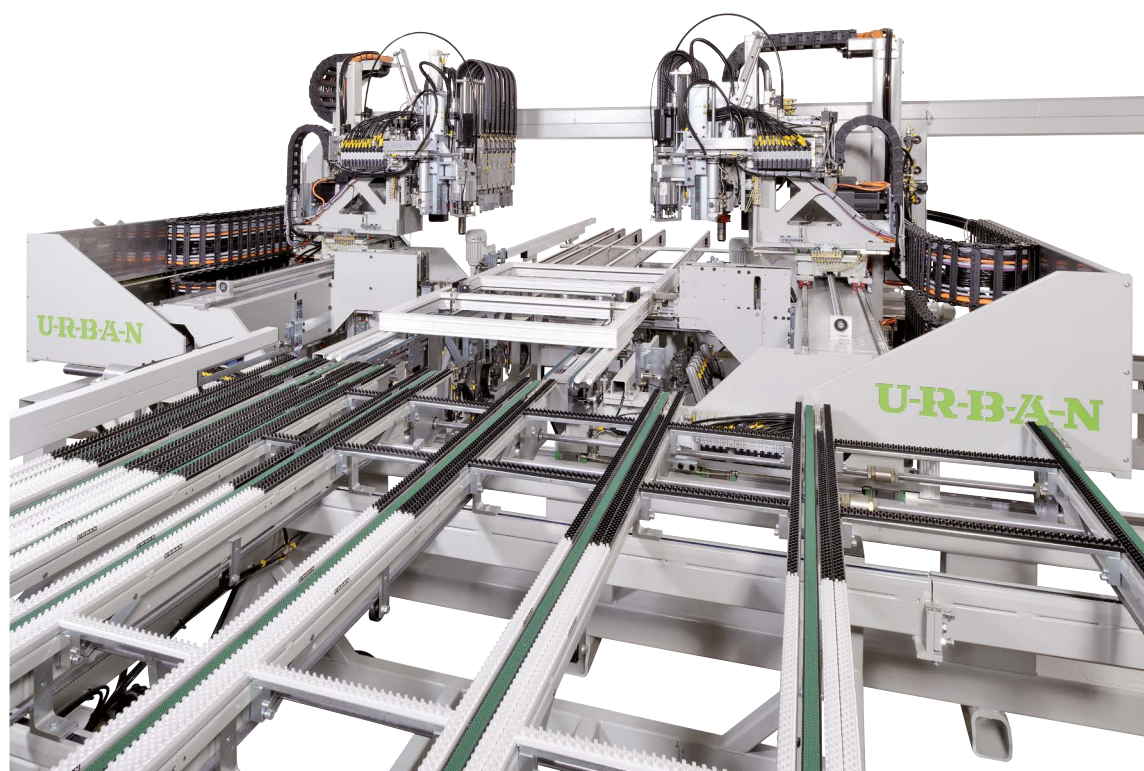

Technical information

Sample layout

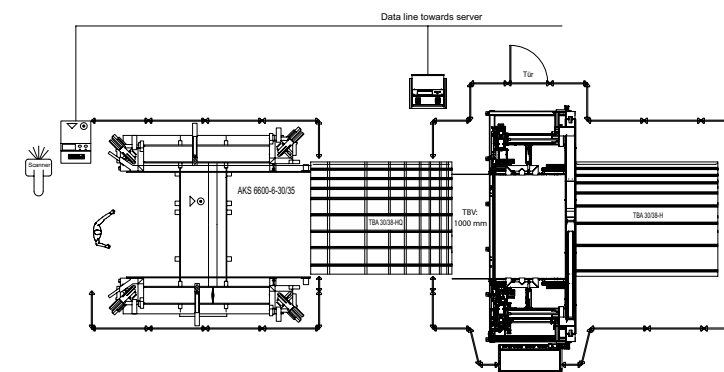

5170 kg



230 / 400 V, 50 - 60 Hz
L1-L2-L3-N-PE
6 kW / 12 A (for minimum extension level)



7 bar



approx. 750 litres
air consumption per frame

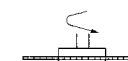

5400 1/min

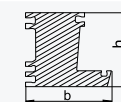

h max. = 130 mm / h min. 40 mm
h max. = 200 mm / h min. 50 mm
b max. = 150 mm
b min. = 40 mm

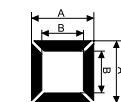

A max. = 2500 / 3000 mm
B min. = 195 - 270 mm
C min. = 160 - 220 mm
(depending of profile and tooling equipment)

Technical data are valid for basic machine without options. Size according to layout.

Product data sheet
SV 840
01/22 PR50082

Urban GmbH & Co. Maschinenbau KG

Dornierstraße 5
DE - 87700 Memmingen
Tel.: +49 (0) 8331 858 - 0
E-Mail: urban@u-r-b-a-n.com
www.u-r-b-a-n.com

SV 840

CNC-Corner Cleaning Machine

U-R-B-A-N

Trust. Right from the start!

Easy handling

Graphic visualization of the profiles and convenient simulation of all machining steps ensure easy handling of the machine.

Solid design

Heavy-duty guides are the guarantee for a sturdy and solid machinery structure allowing for high process reliability and longevity of the machine.

Cost-effective

Due to the special arrangement of the units, blocking of both processing heads is not necessary anymore and ensures shortest cycle times.

PVC cleaning in a new dimension

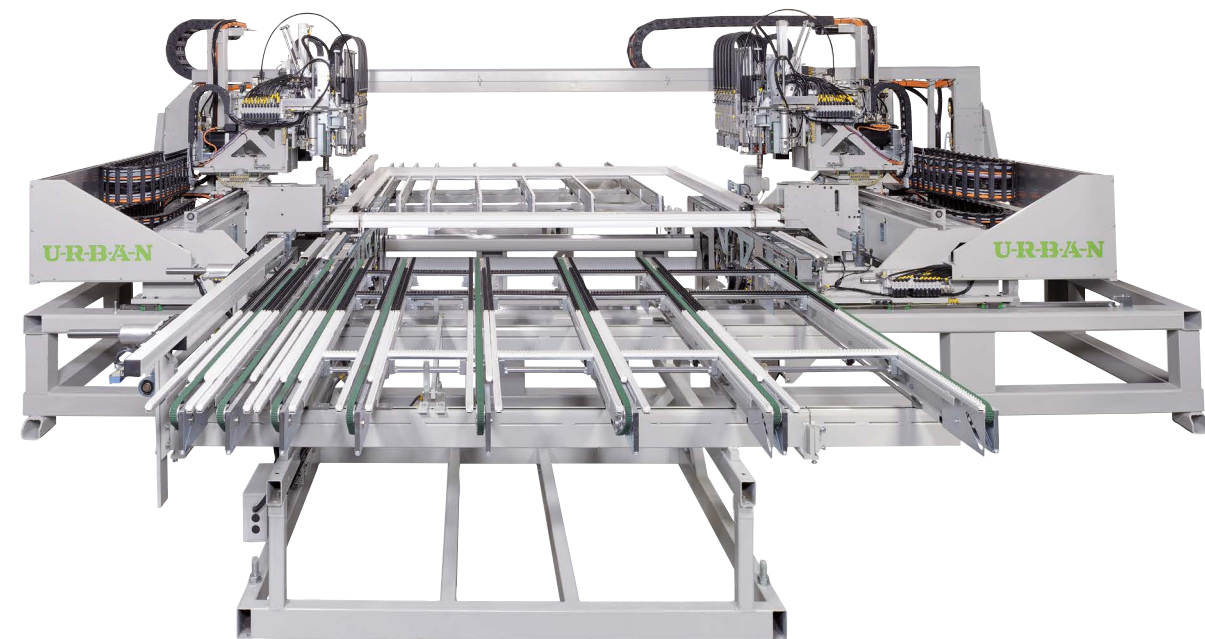

Sophisticated design

Due to the modular structure of the SV 840, new profile processings as well as retrofitting of toolings can be materialized quite easily.



Highest precision

Measuring and complete clamping of the window elements are the guarantee for highest processing and repeating accuracy.



Highest flexibility

The inner stop ensures highest flexibility for machining of overlap, transom, cross and frame combinations.



Additional possibilities

The three dimensional processing offers additional possibilities e.g. machining out of 45° mitre range, compensation of the processing centre etc.